

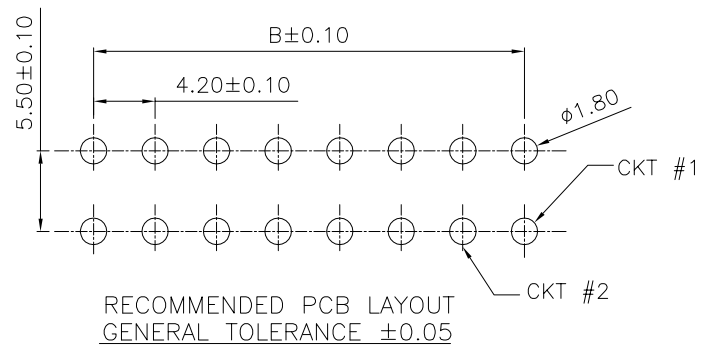

A | B | C | D | E | F

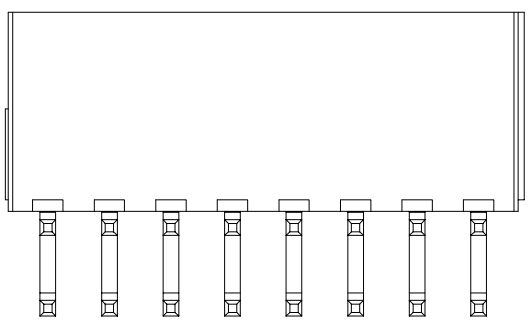
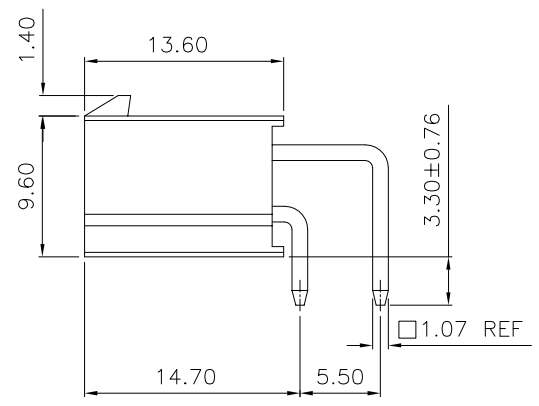
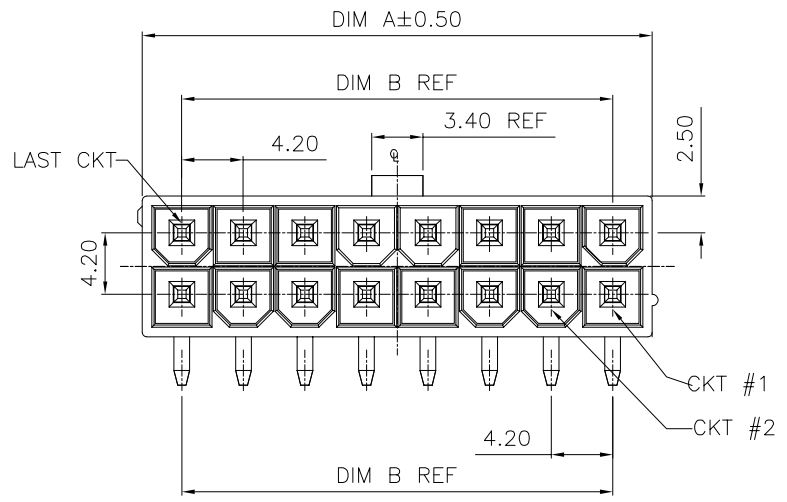
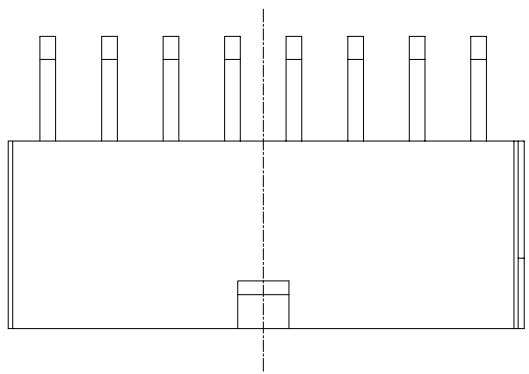

NOTES:  
 1. MATERIAL:  
 1.1 HOUSING: THERMOPLASTIC  
 1.2 CONTACT: COPPER ALLOY  
 2. FINISH:  
 2.1 CONTACT:  
 50u" MIN. NICKEL UNDERPLATING OVERALL  
 100u" MIN MATTE TIN  
 3. SPEC. PLS. REFER TO PS-57955-xxxxx-xxx  
 4. PACKAGE PLS. REFER TO 57953-XXXXX-XX-TRP  
 57955-TB  
 5. PART NUMBER  
 57953-XXX X X-XXX  
 NO OF CKT | | 001:NORMAL  
 PACKING | | PLATING  
 0:TAPE & REEL | | N: MATT TIN  
 1:TUBE

CKT	DIM A	DIM B
2	5.4	NA
4	9.6	4.20
6	13.8	8.40
8	18.0	12.60
10	22.2	16.80
12	26.4	21.00
14	30.6	25.20
16	34.8	29.40
18	39.0	33.60
20	43.2	37.80
22	47.4	42.00
24	51.6	46.20

一般公差 <b>TOLERANCES</b> X +0.5 XX ±0.25 X ±0.38 XXX ±0.15 ANGLES ±2°		<b>宏致電子股份有限公司</b> <b>Aces Electronics Co.,Ltd.</b>	
檢驗尺寸標示 SYMBOLS Ⓢ Ⓣ INDICATE CLASSIFICATION DIMENSION Ⓢ MARK IS CRITICAL DIM. Ⓣ MARK IS MAJOR DIM.	品名 (TITLE) 4.2mm Pitch Header Conn. T/H D/R R/A Type	製圖 (DR) ECHO 17/02/08 審核 (CHKD) ANDREW	圖號 (DWG NO.) 57953-XXXXX-XXX
表面處理 (FINISH)	比例 (SCALE) 2:1	單位 (UNITS) mm	張數 (SHEET) 1 OF 2 核淮 (APPD) CHARLESLEE SIZE A4 REV 0

A | B | C | D | E | F

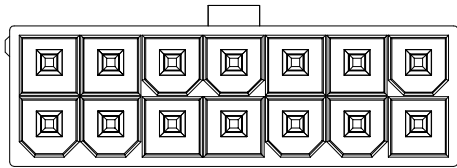

14-CKT

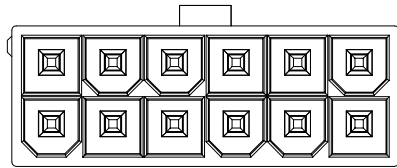

12-CKT

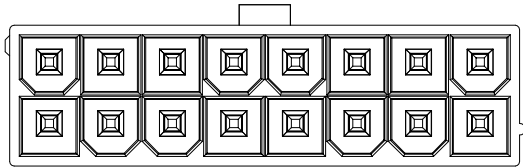

16-CKT

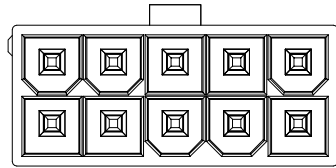

10-CKT

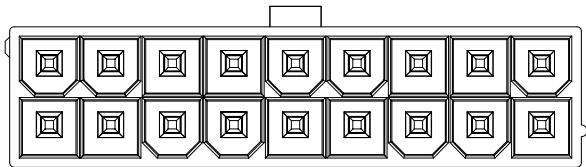

18-CKT

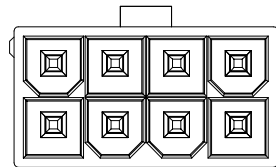

8-CKT

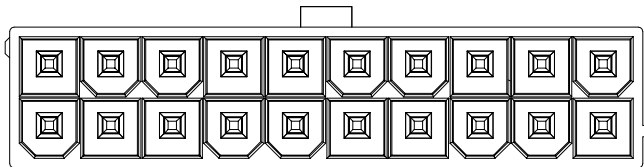

20-CKT

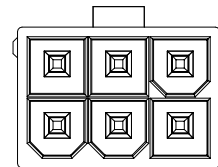

6-CKT

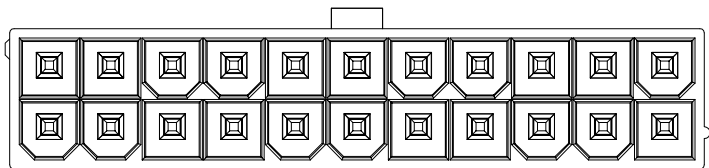

22-CKT

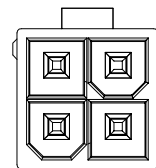

4-CKT

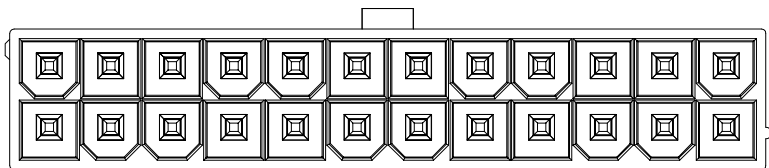

24-CKT

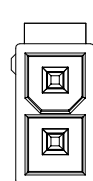

2-CKT

一般公差 <b>TOLERANCES</b> X +0.5 .XX ±0.15 X +0.25 .XXX ±0.1 ANGLES ±2°		<b>宏致電子股份有限公司</b> <b>Aces Electronics Co.,Ltd.</b>	
檢驗尺寸標示 SYMBOLS  INDICATE CLASSIFICATION DIMENSION	品名 (TITLE) 4.2mm Pitch Header Conn.	製圖 (DR) ECHO 17'/02/08	審核 (CHKD) ANDREW 核准 (APPD) CHARLESLEE
	圖號 (DWG NO.) 57953-XXXXX-XXX		
MARK IS CRITICAL DIM. MARK IS MAJOR DIM.	比例 (SCALE) 2:1	單位 (UNITS) mm	
表面處理 (FINISH)		張數 (SHEET) 2 OF 2	尺寸 (SIZE) A4 版數 (REV) 0